

DERMALINE™

PRECISION Personal Hair Remover

INCLUDES:

- 1 Dermaline™ Precision Hair Remover With Pivoting Head
- 1 2.4 mm comb attachment
- 1 6 mm comb attachment
- 1 Cleaning Brush
- 1 AAA Battery

INSTRUCTIONS FOR USE:

INSTALL BATTERY

1. Pull apart top and bottom of unit. (Illust.1)
2. Insert AAA battery into battery compartment, following the +/- indicators. (Illust.2)

2. HOW TO USE

NOTE: Before first use, it is recommended that you test the unit on a small area of your arm or leg. If sensitivity or allergic reactions occur, discontinue use.

- Do not use on irritated skin, open wounds or on breakouts. If skin irritation occurs, discontinue use.

DO NOT USE ON WET SKIN

- Remove cap and slide power switch to the "ON" position. (Illust. 3)
- Hold the unit at a 45° angle to your face and trim in the opposite direction of hair growth. Pull skin taut with your other hand while trimming. (Illust.4)

DO NOT APPLY EXCESSIVE PRESSURE. DOING SO COULD RESULT IN INJURY TO THE SKIN AND DAMAGE TO THE UNIT HEAD.

COMB ATTACHMENTS

The Dermaline™ Precision Personal Hair Remover includes 2 comb attachments for trimming eyebrows.

Use the 2.4 mm comb for trimming shorter eyebrows.

Use the 6 mm comb for trimming longer eyebrows.

- Turn unit off.
- Slide selected comb attachment onto unit head making sure to align the grooves on the attachment with the grooves on the unit head. Make sure your selected trimming size is facing the same direction as the unit head.
- To remove comb, turn unit off and slide comb off unit head.

PIVOTING HEAD

- Remove cap and turn unit off.
- Move head gently to the right. (Illust. 5). Make sure head is locked into position before use.
- To put head back to its original upright position, turn unit off and gently move head to the left.

CLEANING

- Turn unit off and remove battery. (See Step 2 above)
- Use the included cleaning brush to gently wipe away any hair or dust. DO NOT remove any foreign matter with a sharp object.
- Replace cap when storing unit. If you do not intend to use your Dermaline™ Precision for an extended period of time, remove the battery before storing.

CAUTION:

- Not intended for persons under 12 years of age.
- Use only as intended as per this manual.
- Do not use on irritated skin, open wounds or on breakouts. If skin irritation occurs, discontinue use.
- Exercise caution when using around eyes.
- Do not submerge unit or rinse head in water.
- Do not put used batteries in fire as they could explode or leak. Dispose according to all local regulations.

WARNING:

- Keep out of reach of children

LIMITATION OF LIABILITY

Liability limited to the purchase price of this product.

Supertek Canada Inc. shall not be liable for any incidental or consequential damages or any implied warranty on this product.

Distributed by:
Supertek Canada Inc.
Mont-Royal, QC H4T 1X2

www.clikit.ca

Customer Service: 1-800-304-8354

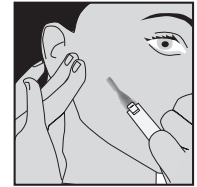
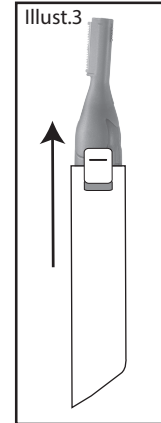
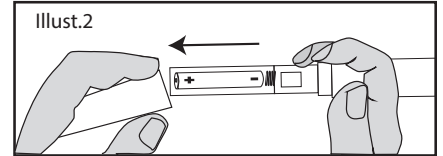
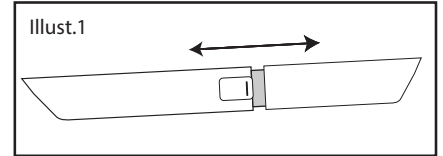

Illust.4



Illust.5