

## USER MAINTENANCE INSTRUCTIONS:

- No lubrication is necessary. Keep all surfaces clean and free of dust, dirt or debris.
- If any malfunction occurs, DO NOT attempt to repair the unit. This appliance has no user-serviceable parts

## CAUTION:

1. Shower use only. Do not submerge! Not for use in bath tubs!
2. Supervision is recommended when this appliance is used by/on/or near individuals with disabilities.
3. Use this appliance only for its intended uses as described in this manual. DO NOT use attachments that are not included in the Spin Spa offering.
4. Do not use this product if battery compartment is exposed or battery door is not fully installed.
5. Keep away from heated surfaces
6. DO NOT mix old/new batteries
7. DO NOT mix alkaline, standard, or rechargeable batteries.
8. Batteries must be recycled or disposed of properly.
9. Do not use on broken skin or areas of the skin with a rash, severe acne or other skin ailments.
10. Keep away from hair.

**SAFETY FEATURE:** To prevent damage, the attachments are designed to come loose & may fall off if too much pressure is applied.



## Cleansing Facial Brush



Distributed by: Wayne, NJ 07470  
Made in China © 2016 Ideavillage  
customerservice@ideavillage.com  
SPNSPF010517MW

## ATTACHMENTS/FEATURES:

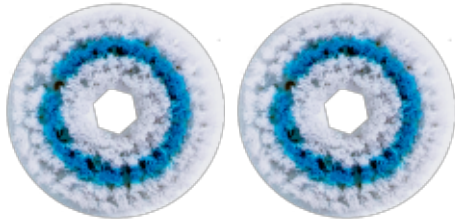

**2 Cleansing Attachments**  
Gentle Cleaning



**NOTE:** The Spin Spa is designed for use in shower or sink only. Do not submerge or use in bathtub. This unit is meant for gentle cleansing only. As a precaution, if too much pressure is applied, unit will stop.

## INSTALLING/CHANGING THE BATTERIES:

**Spin Spa Facial** requires one (1) AA Battery (not included)

1. Push tab to remove battery door and install battery (see Illustrations #1 & #2).
2. Insert 1 new AA battery (not included).
  - Do not get water into battery compartment.
  - Do not open compartment while showering.
  - Be sure that you and appliance are completely dry before opening the battery door.
3. Replace the battery door by sliding the end into opening (see Illustration #3) and snap into place.

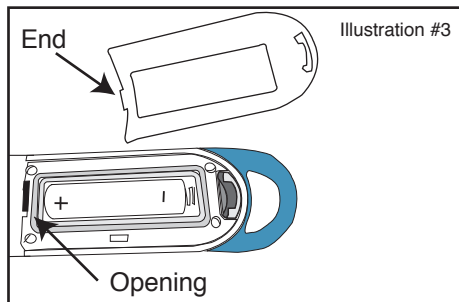
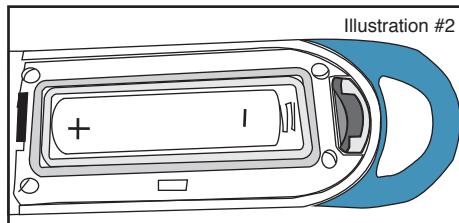
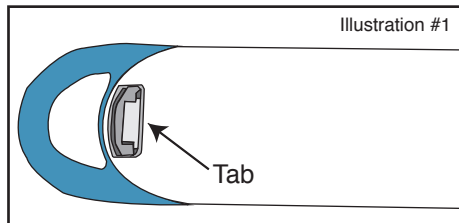

## USING YOUR SPIN SPA:

1. Align and attach the desired attachment to the **Spin Spa Facial** Head (See illustration #4).
2. To change attachments pull outwards (See illustration #5).
3. Apply soap to the brush attachment.
4. Press "On/Off" button, to activate **Spin Spa Facial** (See illustration #6).

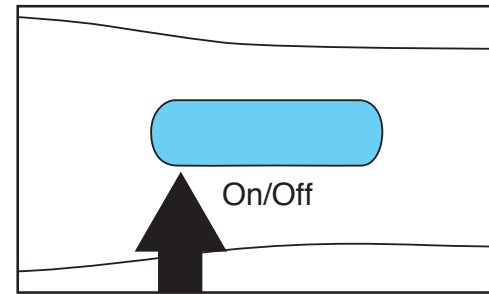
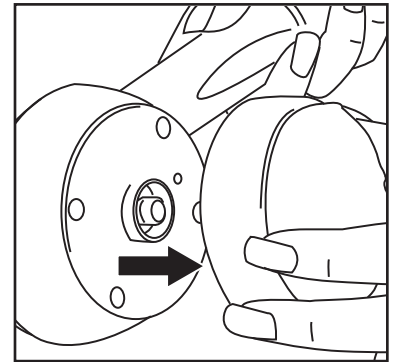
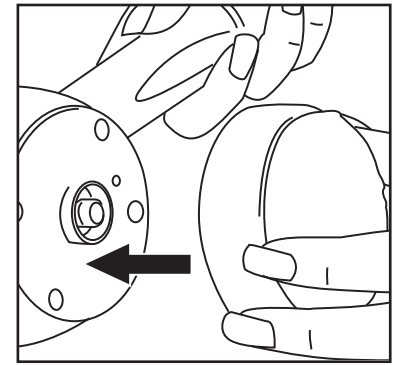

## CLEANING YOUR SPIN SPA:

1. Rinse soap from attachments with warm water after every use, allow attachments to dry completely before reattaching to the handle.
2. Wipe **Spin Spa Facial** with a damp cloth.

