

**IMPORTANT SAFETY INSTRUCTIONS, READ AND FOLLOW ALL WARNINGS AND INSTRUCTIONS BEFORE USING THIS PRODUCT. INJURY CAN RESULT FROM IMPROPER USE.**

**WARNING**

- To avoid risk of suffocation, keep all plastic bags away from children.
- Do not plug in product until all packaging materials have been taken off the Red Copper™ 5 Minute Chef.
- Carefully monitor Red Copper™ 5 Minute Chef whenever it is plugged in or cooling.
- Before first use, make sure to clean the Red Copper™ 5 Minute Chef as explained in these instructions.
- This product is for home use only. It is not intended for camping or commercial use.
- Do not use outdoors.
- Prior to handling or cleaning Red Copper™ 5 Minute Chef, let cool for five minutes.
- Unplug from outlet when not in use and before cleaning. Allow to cool before putting on or taking off parts, and before cleaning Red Copper™ 5 Minute Chef.
- Store out of reach of children. This product is not a toy. Carefully monitor any children who may come near the Red Copper™ 5 Minute Chef.
- When lifting the cover, always lift with your arm to the side of the Red Copper™ 5 Minute Chef and not directly above the cooking surface. The cooking surface becomes hot during use and can cause burns.
- Do not use sharp or metal kitchen utensils that can damage the surface of Red Copper™ 5 Minute Chef.
- Do not operate Red Copper™ 5 Minute Chef with a damaged cord or plug or after Red Copper™ 5 Minute Chef malfunctions, or has been damaged in any manner. Refer to the nearest authorized service facility for examination, repair or adjustment.
- Do not abuse the cord. Do not carry the Red Copper™ 5 Minute Chef by the cord or yank the cord to disconnect. Keep power cord away from heat and sharp edges.
- Keep the cord away from heat sources and table edges.
- Red Copper™ 5 Minute Chef should always be used and stored away from sinks and hot surfaces.
- To protect against electric shock do not immerse cord, plugs, or Red Copper™ 5 Minute Chef in water or other liquid.
- Do not operate Red Copper™ 5 Minute Chef if the power cord has received a sharp blow, been dropped or otherwise damaged in any other way.
- Always store this unit indoors.
- Do not operate in the presence of explosives and/or other flammable fumes or liquids.
- Do not store or use this product near sources of heat or fire.
- While the Red Copper™ 5 Minute Chef is turned on or cooling down, do not touch any part of the Red Copper™ 5 Minute Chef other than the handle. Only the handle should be used for opening and closing the cover.
- Extreme caution must be used when moving Red Copper™ 5 Minute Chef containing hot oil or other hot liquids.
- Red Copper™ 5 Minute Chef is not dishwasher or oven safe.
- Failure to read and follow all warnings and instructions may lead to injury to person and property.
- Do not use Red Copper™ 5 Minute Chef for other than intended use.
- The use of accessory attachments not recommended by the Red Copper™ 5 Minute Chef manufacturer may cause injuries.
- To disconnect, turn any control to "off", then remove plug from wall outlet.

**SAVE THESE INSTRUCTIONS - HOUSEHOLD USE ONLY**

**How to Use**

You can make more than omelets with Red Copper™ 5 Minute Chef. These instructions show how to use this product for making omelets. Please refer to the included recipe book for other cooking ideas.



- Put the Red Copper™ 5 Minute Chef on a flat, dry, sturdy surface and plug in the power cord. The red indicator light lets you know that the product is on and the cooking surfaces are getting hot. (Figure A)
- Pre-prepare beef, wash 2 eggs. (Figure B)
- The cooking surfaces are ready for your food once the power light becomes illuminated. (Figure C)



- Raise the cover with care. You may wish to add a small amount of butter or oil to the cooking surfaces through the lid if necessary. Next, place the fillings with the lower cooking surface and lift gently with the provided spatula until fully cooked. (Figure D)
- Pour the eggs into the bottom cooking surface. Do not let the oil cover the bottom cooking surface. (Figure E)
- Lock the latch located on the front of the Red Copper™ 5 Minute Chef by pressing down on the latch until you hear a click. (Figure F) Allow the eggs to cook for 3-4 minutes.



- When your omelet is done cooking, use the provided spatula to remove the omelet from the Red Copper™ 5 Minute Chef. (Figure G)

No need to No use Red Copper™ 5 Minute Chef when you're moving eggs over.

**WARNING**

Do not use this product on wet surfaces. If metal contact is made with Red Copper™ 5 Minute Chef, it may cause a fire or electric shock. Do not use this product on wet surfaces. Do not use this product on wet surfaces.

**CAUTION**

- Red Copper™ 5 Minute Chef has a polarized plug (one blade is wider than the other). To reduce the risk of electric shock, this plug is intended to fit into a polarized outlet only one way. If the plug does not fit fully into the outlet, reverse the plug. If it still does not fit, contact a qualified electrician. Do not attempt to modify the plug in any way.
- A short power-supply cord (or detachable power-supply cord) is to be provided to reduce the risk resulting from becoming entangled in or tripping over a longer cord.
- Longer detachable power-supply cords or extension cords are available and may be used if care is exercised in their use.
- If a long detachable power-supply cord or extension cord is used:
  - The marked electrical rating of the cord or extension cord should be at least as great as the electrical rating of the appliance;
  - The longer cord should be arranged so that it does not drape over the countertop or table top where it can be pulled on by children or tripped over unintentionally.

**Before First Use**

Clean the cooking surfaces by using a soft sponge that has been dipped into warm soapy water. Dry with a soft towel or allow to air dry. **Do not immerse in water.**

**Product Components**

- A. Cooking Surfaces
- B. Latch
- C. Handle
- D. Cover
- E. Red Indicator Light
- F. Green Indicator Light
- G. Power Cord
- H. Spatula

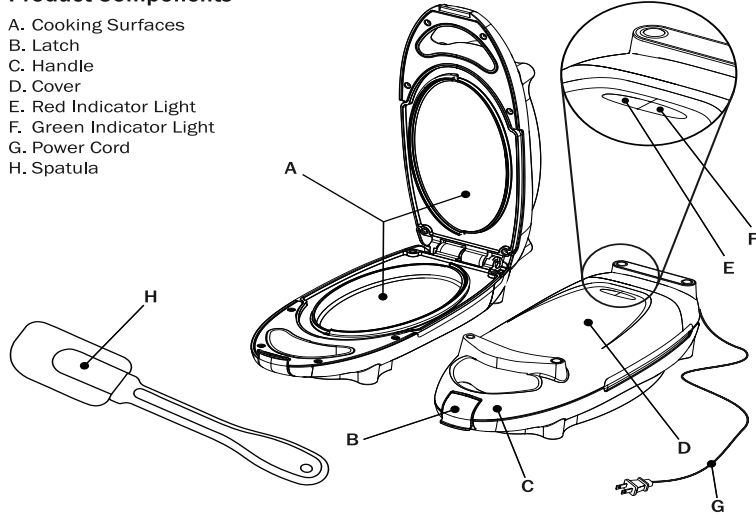

PRODUCT MAY VARY FROM IMAGES SHOWN

**Important Precautions**

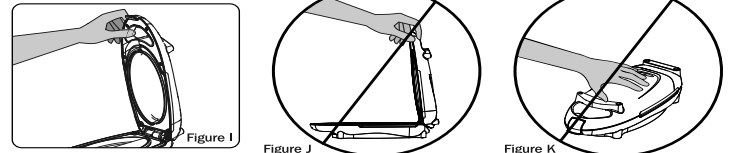

- When lifting and lowering the cover, always lift from the side of the handle. (Figure I)
- Never lift the cover so that your arm or any part of your body is directly over the cooking surface. Escaping steam can cause serious injury. (Figure J)
- Do not touch or handle any part of the Red Copper™ 5 Minute Chef besides the handle when the Red Copper™ 5 Minute Chef is plugged in or cooling down. (Figure K)

**Cleaning**

Before doing any sort of cleaning, unplug the Red Copper™ 5 Minute Chef and let it cool for five minutes. Do not use any sort of abrasive cleaners or brushes on any of the surfaces.

- Cleaning can be done by using warm soapy water and a soft sponge. Dry with a soft towel or allow to air dry.
- If you notice that some areas of the cooking surface have burnt food stuck onto them, you can remove it by putting a small amount of cooking oil on the area and waiting ten minutes. Next, remove the food with a soft sponge. Wipe clean with a damp cloth and dry with a soft towel or allow to air dry. Should the problem persist, try again, instead waiting for a longer time period such as several hours instead of ten minutes.
- Before storing, make sure the Red Copper™ 5 Minute Chef is completely dry and clean.

This AC wire carrier current device of unintentional radiator is a Category II equipment compliant with Industry Canada's ICES-006.

**LIMITATION OF LIABILITY**  
 Liability limited to the purchase price of this product.  
 Supertek Canada Inc. shall not be liable for any incidental or consequential damages or any implied warranty on this product.