

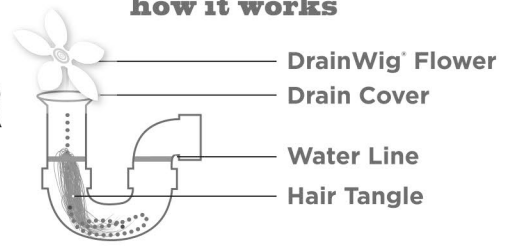

DRAINWIG® HAIR CATCHER FOR SHOWERS

how it works



INSTALLATION:

FIRST TIME USE: EXISTING HAIR OR CLOG MUST BE REMOVED FROM DRAIN FOR DRAINWIG® HAIR CATCHER TO WORK PROPERLY. NOTE: IF USING A LIQUID DRAIN CLEANER FOLLOW THE RECOMMENDED INSTRUCTIONS. BE SURE TO THOROUGHLY FLUSH OUT PIPE WITH RUNNING WATER BEFORE INSTALLING YOUR DRAINWIG® HAIR CATCHER.

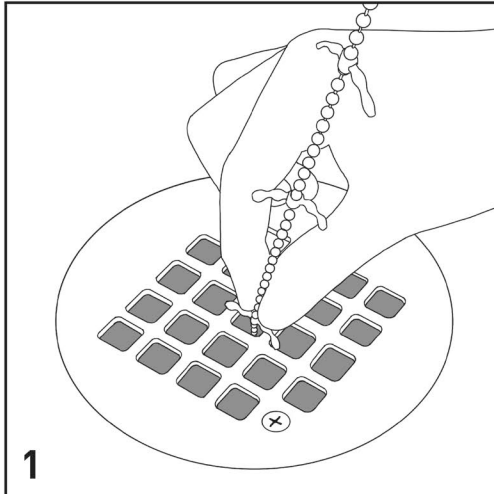

- CLEAR EXISTING CLOG
- INSERT CHAIN
- GUIDE WHISKERS THROUGH DRAIN COVER

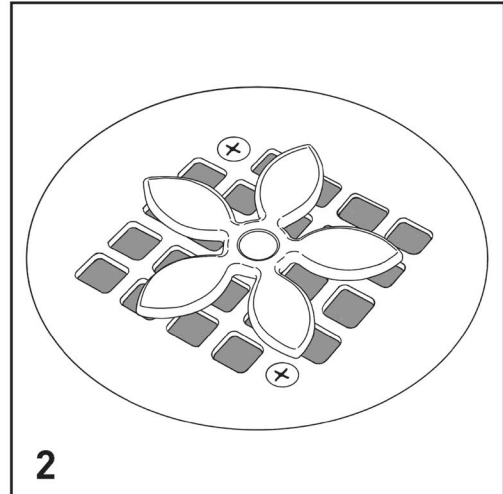

- DAISY CAP LIES FLUSH ON TOP OF DRAIN
- LEAVE IN DRAIN
- HAIR WILL ENTANGLE ON CHAIN

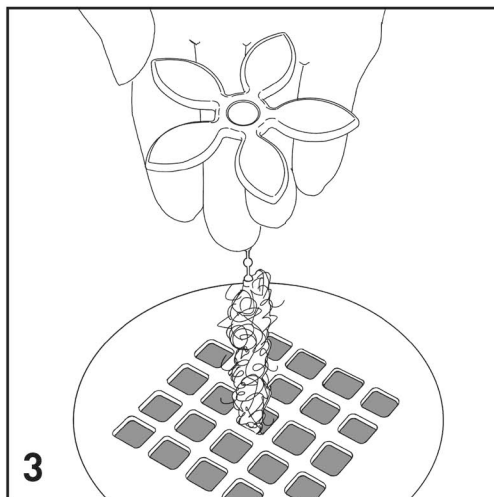

- PERIODICALLY MONITOR THE AMOUNT OF HAIR COLLECTING ON THE DRAINWIG® BY SIMPLY LIFTING THE CHAIN UNTIL YOU SEE THE HAIR APPEAR BELOW THE DRAIN COVER. NOTE: DON'T LET IT GROW BIGGER THAN CAN BE REMOVED THROUGH YOUR DRAIN COVER.
- REMOVE AND REPLACE AS NEEDED (TYPICALLY 2-4 MONTHS).

NOW YOU CAN LET YOUR HAIR DOWN, YOUR DRAINS ARE PROTECTED!

WARNING: KEEP OUT OF REACH OF CHILDREN. THIS PRODUCT IS NOT A TOY. USE THIS PRODUCT ONLY AS INTENDED.

Drainwig is a registered trademark of Washroom Decor, LLC
© 2015 APG
All Rights Reserved.
US Patent # 8910322 & Other Pat. Pending.
Made in China