

## Care and Maintenance

- Keep Dermaplane GLÖ cover on when handling the unit. Uncover when you are ready to use.
- For best results, dispose of Dermaplane GLÖ Head after each use.
- Make sure unit is turned off after use.
- Do not submerge unit in water, or any other liquid.
- Store unit in a dry, safe place.

## Warning

- DO NOT USE Flawless Dermaplane GLÖ on unintended areas of the body (including lips, nose, and directly over the eyelids). Flawless Dermaplane GLÖ is designed for use ONLY on the forehead, above the upper brow, cheeks, upper lip area, and chin.
- DO NOT USE Flawless Dermaplane GLÖ on skin that is experiencing dryness, acne, sunburn, psoriasis, eczema, diabetes, circulatory or bleeding disorders, or on skin that has just been medically treated. Discontinue use if skin irritation occurs.
- DO NOT USE on moles, sores, or lesions.
- DO NOT rinse Handle or unit under water, or submerge in liquid.
- DO NOT dispose of battery in fire; battery may explode.
- Dispose of old batteries according to all applicable local regulations.
- Not intended for persons 12 years of age or under.

LIMITATION OF LIABILITY

Liability limited to the purchase price of this product. Supertek Canada Inc. shall not be liable for any incidental or consequential damages or any implied warranty on this product.

**For additional Flawless items, accessories, how-to-videos and to register your product, please go to [www.FlawlessProducts.ca](http://www.FlawlessProducts.ca)**

Distributed by :  
Supertek Canada Inc.  
Mont-Royal, QC H4T 1X2  
[www.clikit.ca](http://www.clikit.ca)

© IdeaVillage

DM\_FTGLO\_IME\_080919ST

## Lighted Facial Exfoliator



• EXFOLIATES • REMOVES • SMOOTHES

REPLACEMENT HEADS INCLUDED

## Illuminated Facial Exfoliator



- Press the top of the Handle down into the top of the new Head. (Image 7C).

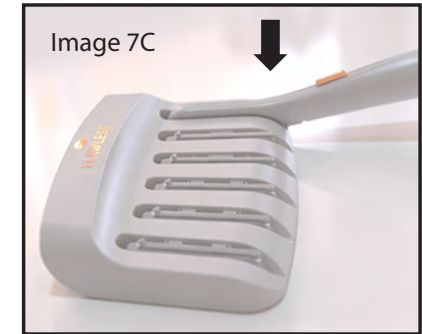

- Rock the Handle backward, being sure to press down until you hear the new head click into place. (Image 7D).

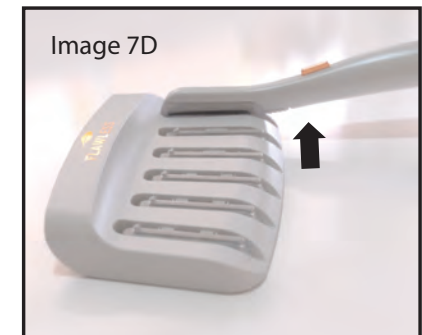

- The unit is now ready for use (Image 7E).

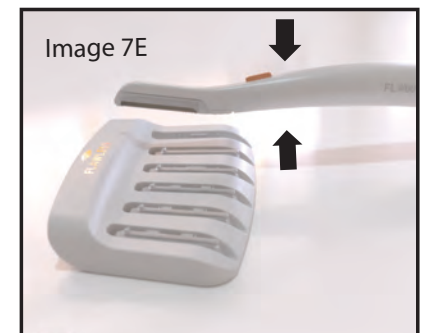

**NOTE: DO NOT USE if Replacement Head appears to be damaged.**

## Replacement Heads

Use a new Dermaplane GLÖ Head for each use.

- Be sure the unit light is off.

- Remove the Head by sliding the Ejection button down (Image 6).

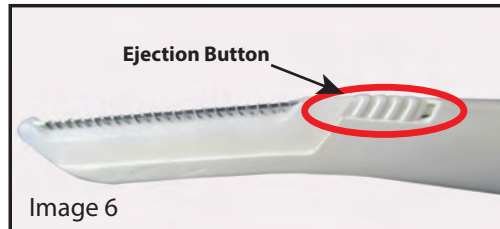

- Discard the old Head.

- Hold the Tray securely with one hand. With the other hand, grasp the Handle.



- Hold the top of the Handle over a new Head (Image 7A).

- Angle the top of the Handle down toward the top of a new Head (Image 7B).



## Getting Started

### PRIOR TO FIRST USE

- **Test on a small, discreet area.**
- **Discontinue use immediately if sensitivity or allergic reaction occurs.**

Flawless Dermaplane GLÖ comes ready to use right out of the package.

Recommended for exfoliation/hair removal on the forehead, above the upper brow, cheeks, upper lip area, and chin.

### INSERT / REMOVE BATTERY

- Gently pull off the Battery Cap to reveal battery compartment (Image 1).
- Place 1 AAA battery into the compartment, making sure the positive pole (+) is facing the top of the unit.
- Push the Cap back securely onto the Handle.
- Repeat for battery replacement.



## How to Use

DRY USE ONLY.

**It is recommended to dermaplane at night, before bed, to give skin time to recover.**

**Be sure to space treatments 1 to 2 weeks apart.**

- Select a new, clean Dermaplane Head for each use.
- With one hand holding the Handle, gently slide the cover off with the other hand (Image 2).
- Press ON button to illuminate area (Image 3).
- For best results, hold the skin taut with your free hand and the unit at a 45° angle with the other.
- Use short, feathery strokes and gently skim across skin, beginning at the hairline and moving inward following the contours of the face (Image 4).
- Do NOT press the Head down into the skin. No pressure should be used. Pass over the same area only ONCE during each use.

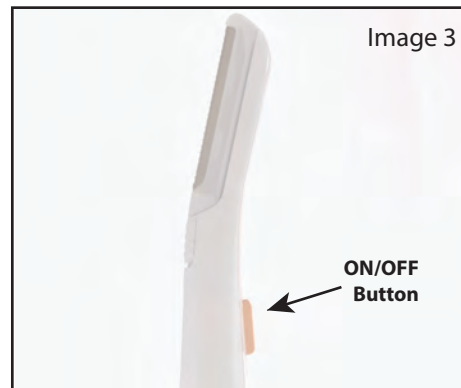
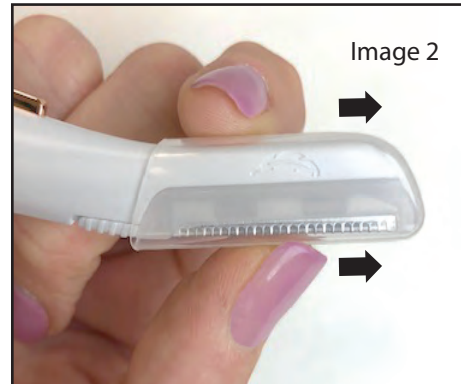

- It is recommended to use the GLÖ in the pattern suggested. (Image 5).

### PRO TIPS

After dermaplaning, let your skin rest.

Do not use creams or make-up for several hours afterward.

### AFTER USE

- Allow skin to breathe for several hours before applying lotions, serums or make-up.
- Applying make-up immediately after using is NOT recommended.
- Do not sunbathe directly after use.

**Note: After use, skin may be slightly pink or red. This is normal after treatment and should fade within a few hours.**

**If redness or burning increases over time, discontinue use of product.**